

www.MotorizedSolutions.com | 1-866-446-6867



Motorized
Solutions

Innovations In Shading Systems

MUD IN HANGER

Typical Results Using Recessed Pocket or Standard Flap and Hanger



Double metal edge



Uneven gaps from wavy drywall

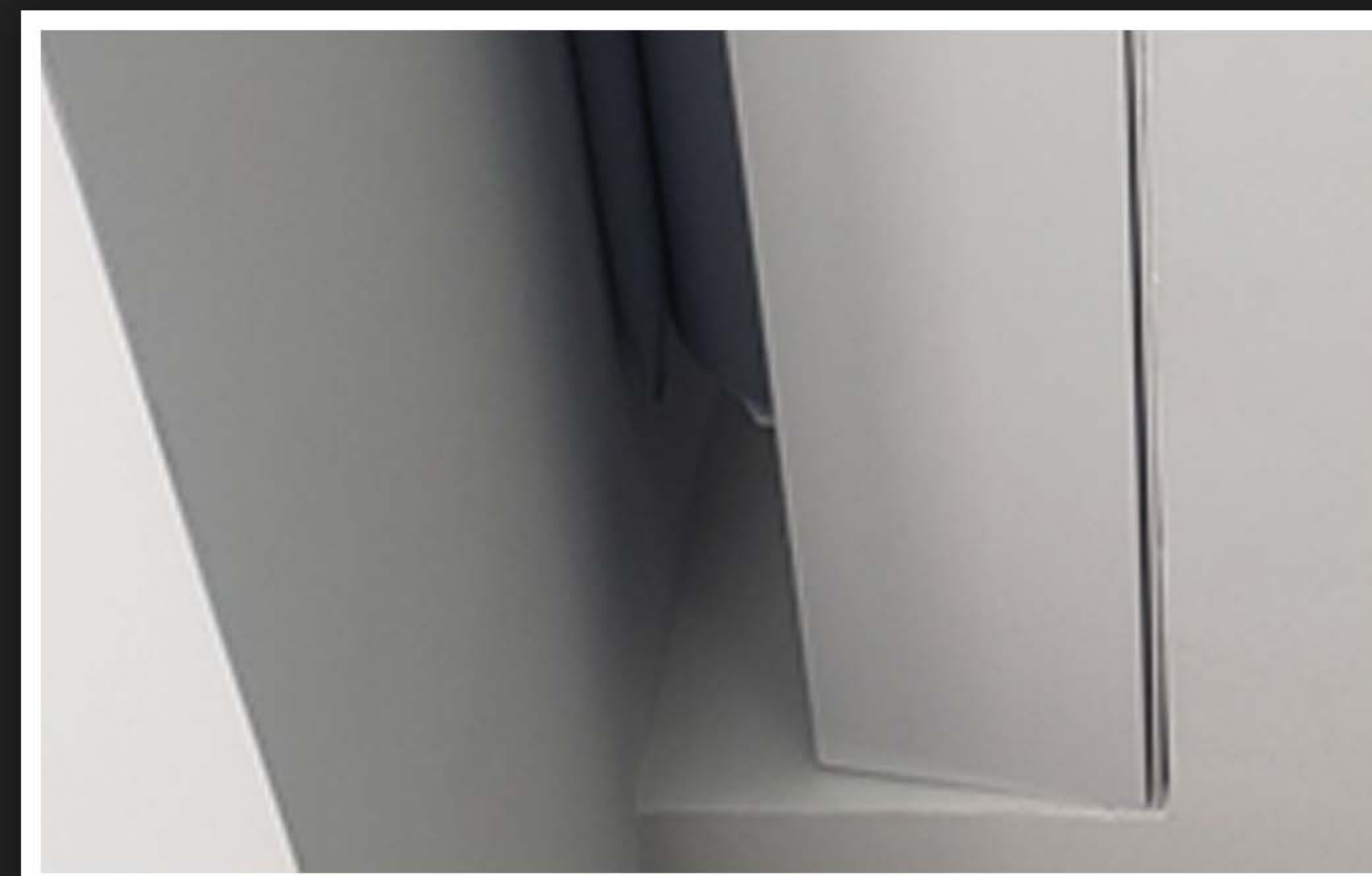

Corners that are not square and level

Reduce Installation Time!

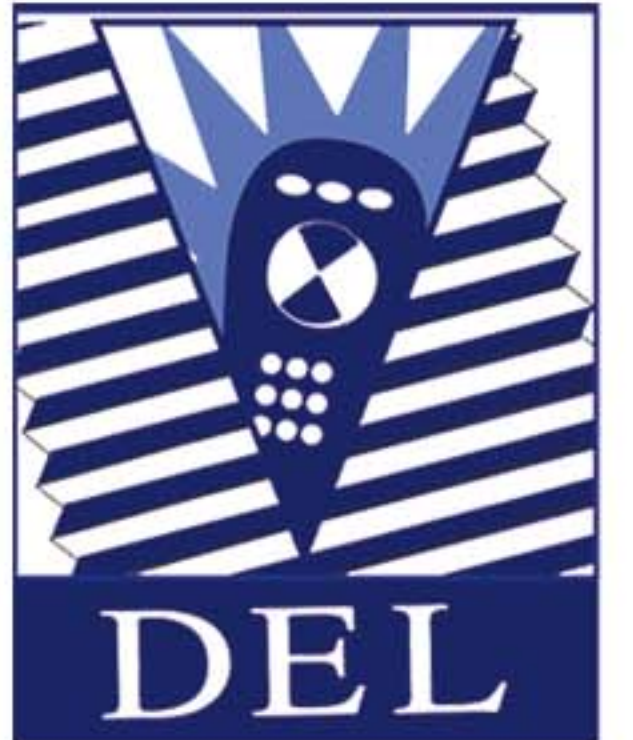

Introducing The DEL Motorized Solutions Perfect Fit Series Mud In Hanger (MIH)!

- You are guaranteed to have the proper depth using the Perfect Fit MIH corners
- No leveling of hanger
 - The hanger is installed during construction. Simply hook on the flap
- No more mitering or feathering of the flap at the corners to compensate for out of square cavities
 - By using the Perfect Fit MIH corner, you are guaranteed a perfectly square edge
- By having the builder construct the cavity with solid plywood or MDF along the top, simple wood screws can be used to anchor the shade brackets, eliminating the possibility of blocking not being in place

Various sizes available

- MIH connects together to seamlessly form any width.
- The hanger is designed for Lutron 2", 3", and 5" flap
- The corners are available in 3.5", 4.75", 6", and 7" depths (custom sizes are available upon request)

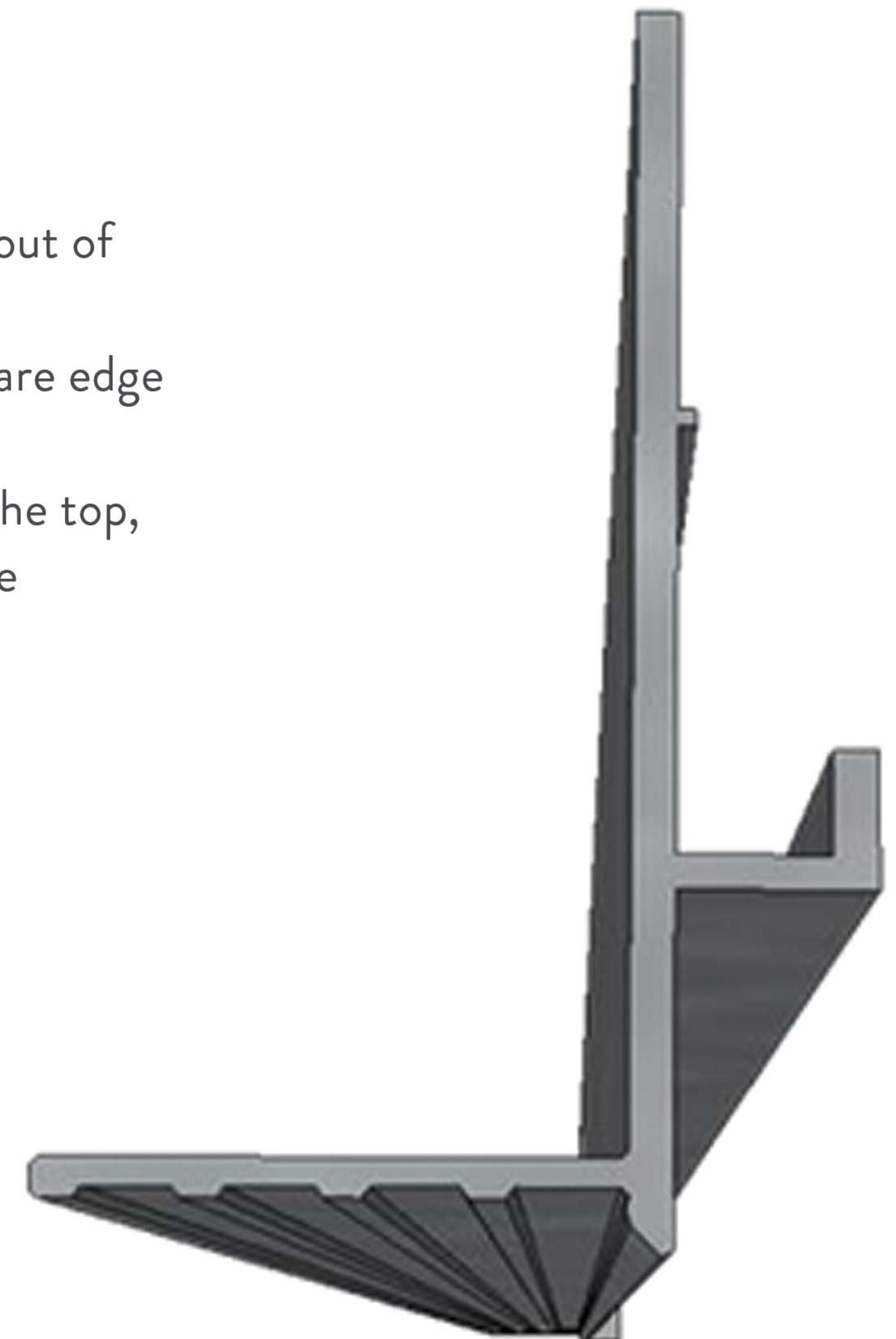

Perfect Fit Mud In Hanger



Optional MIH Return Corners
Available at 3.5", 4.75", 6", 7"
and Custom Sizes

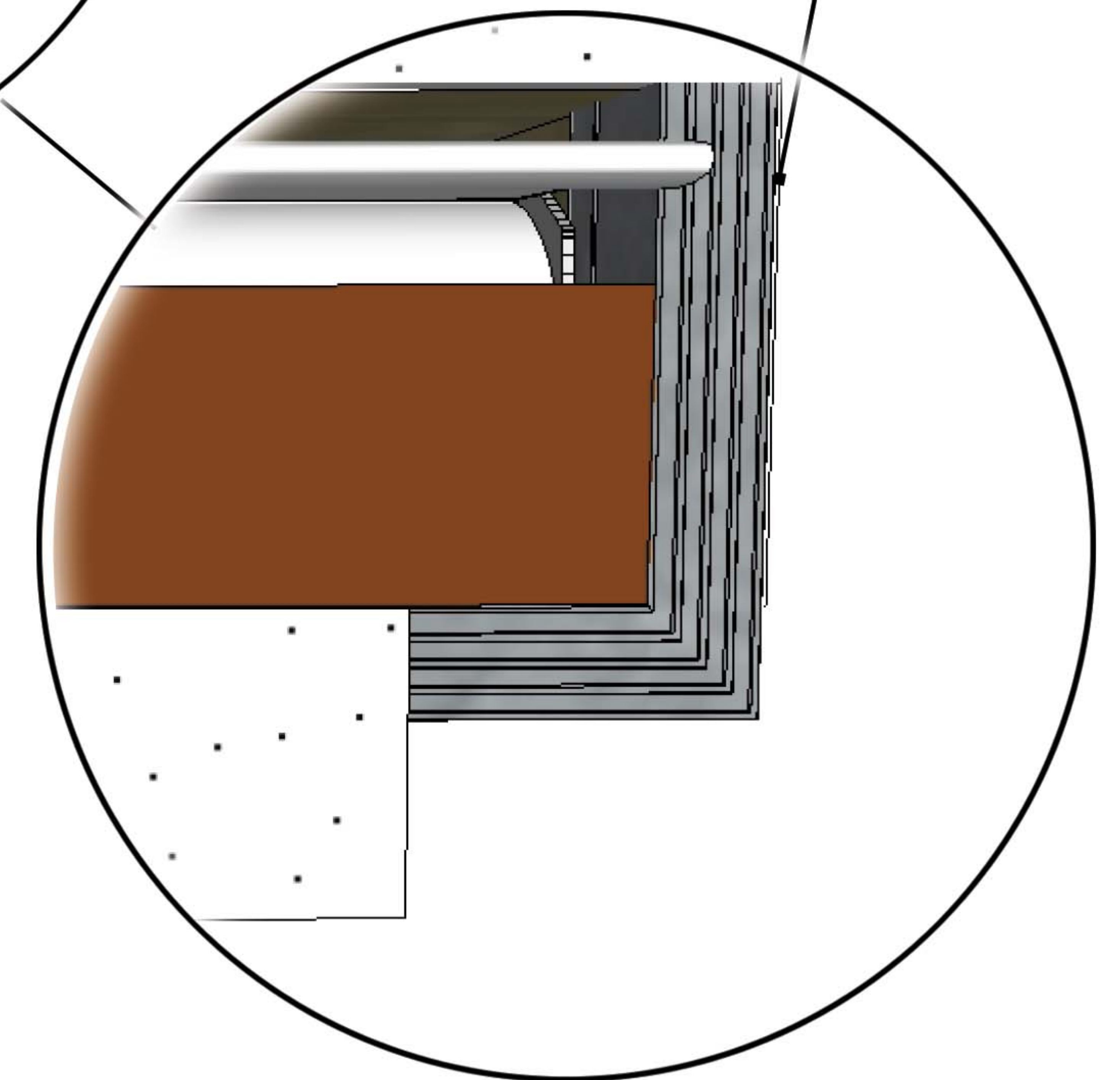
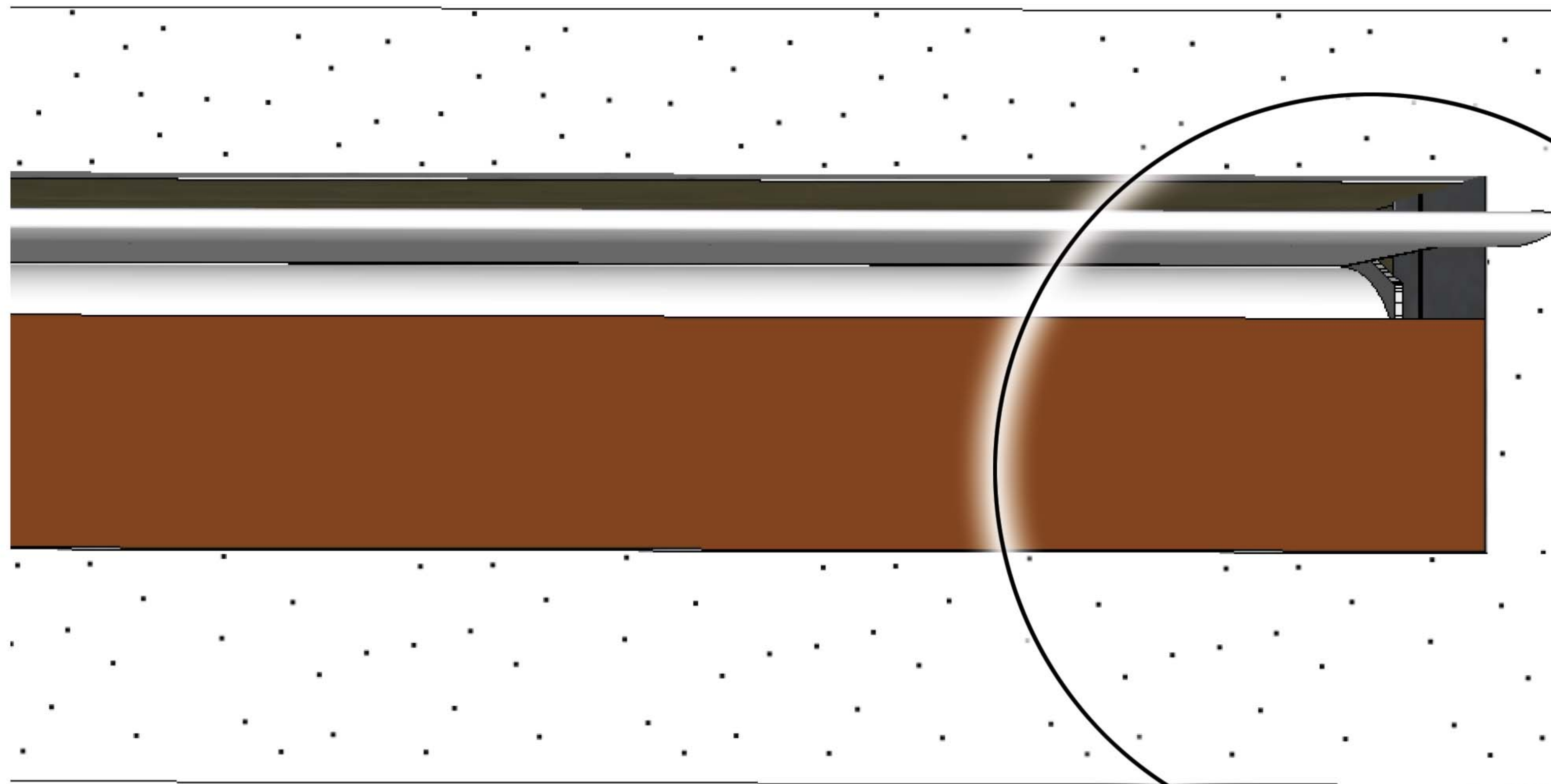

Perfect Fit Mud In Hanger

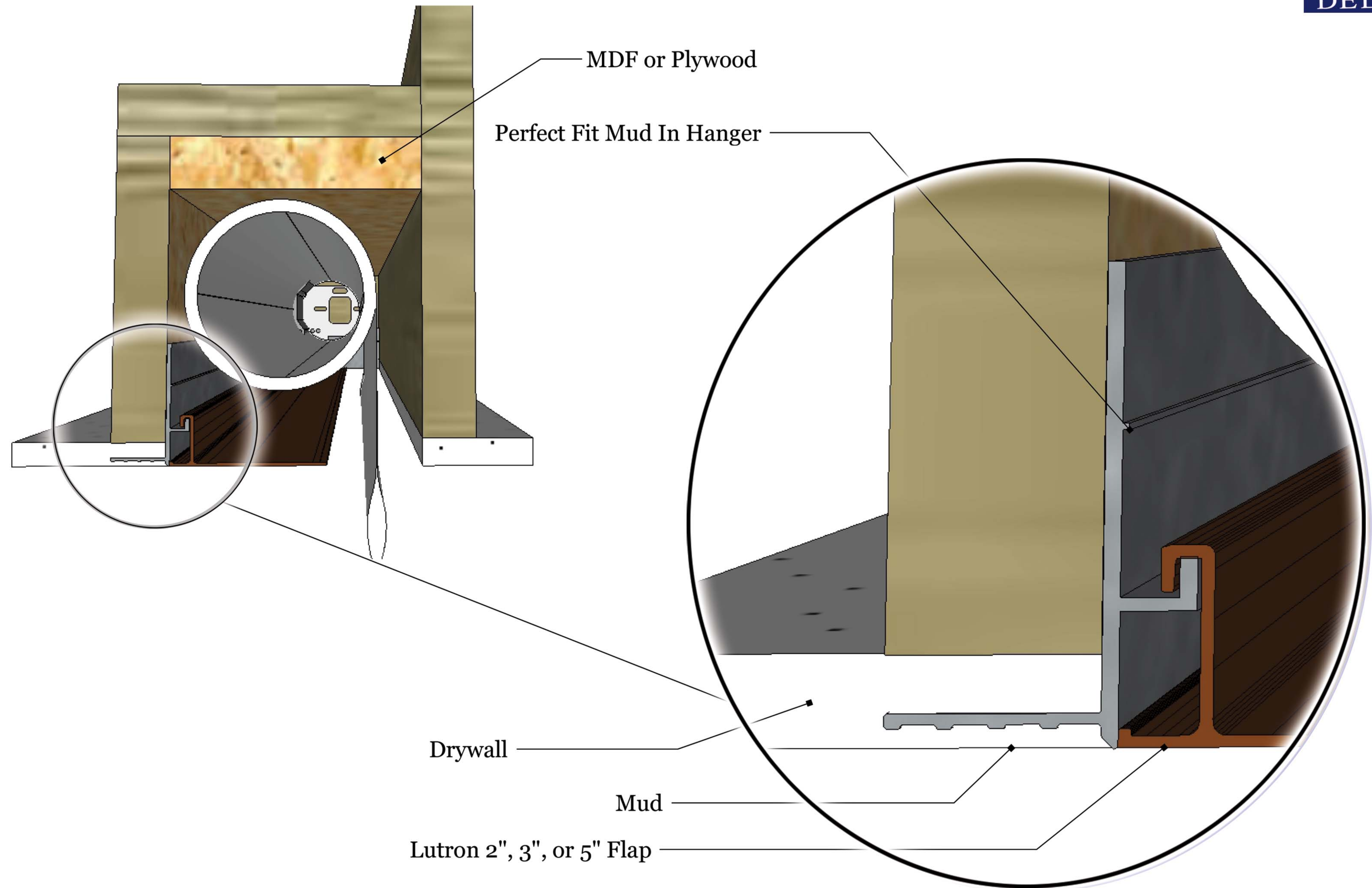

Perfect Fit Mud In Hanger

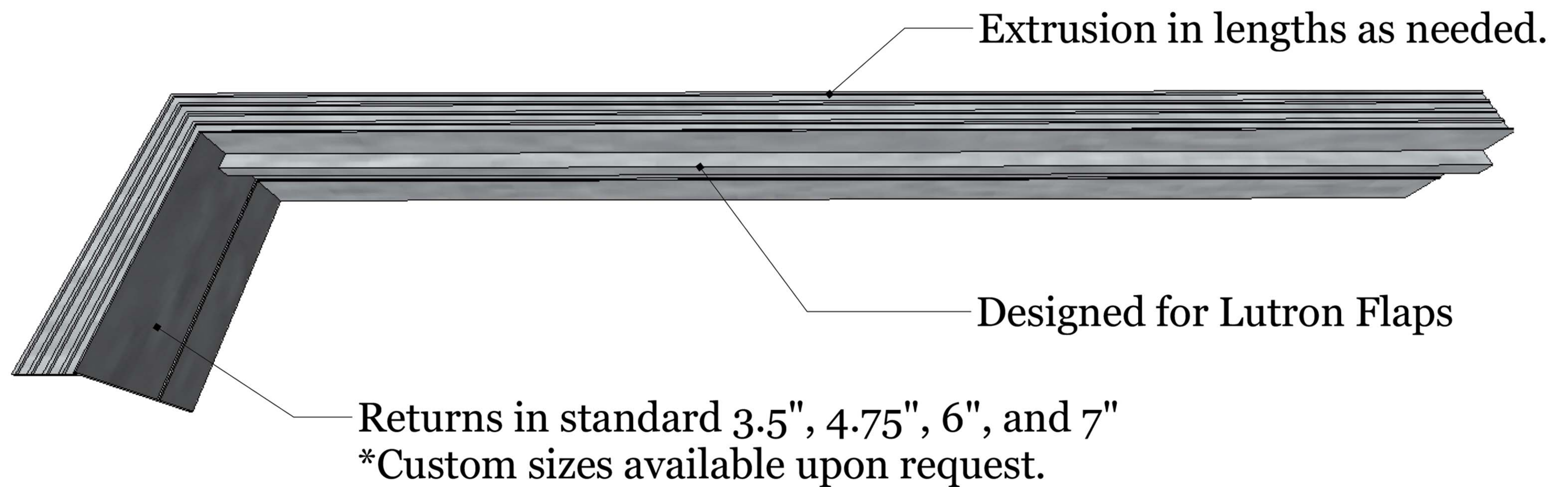
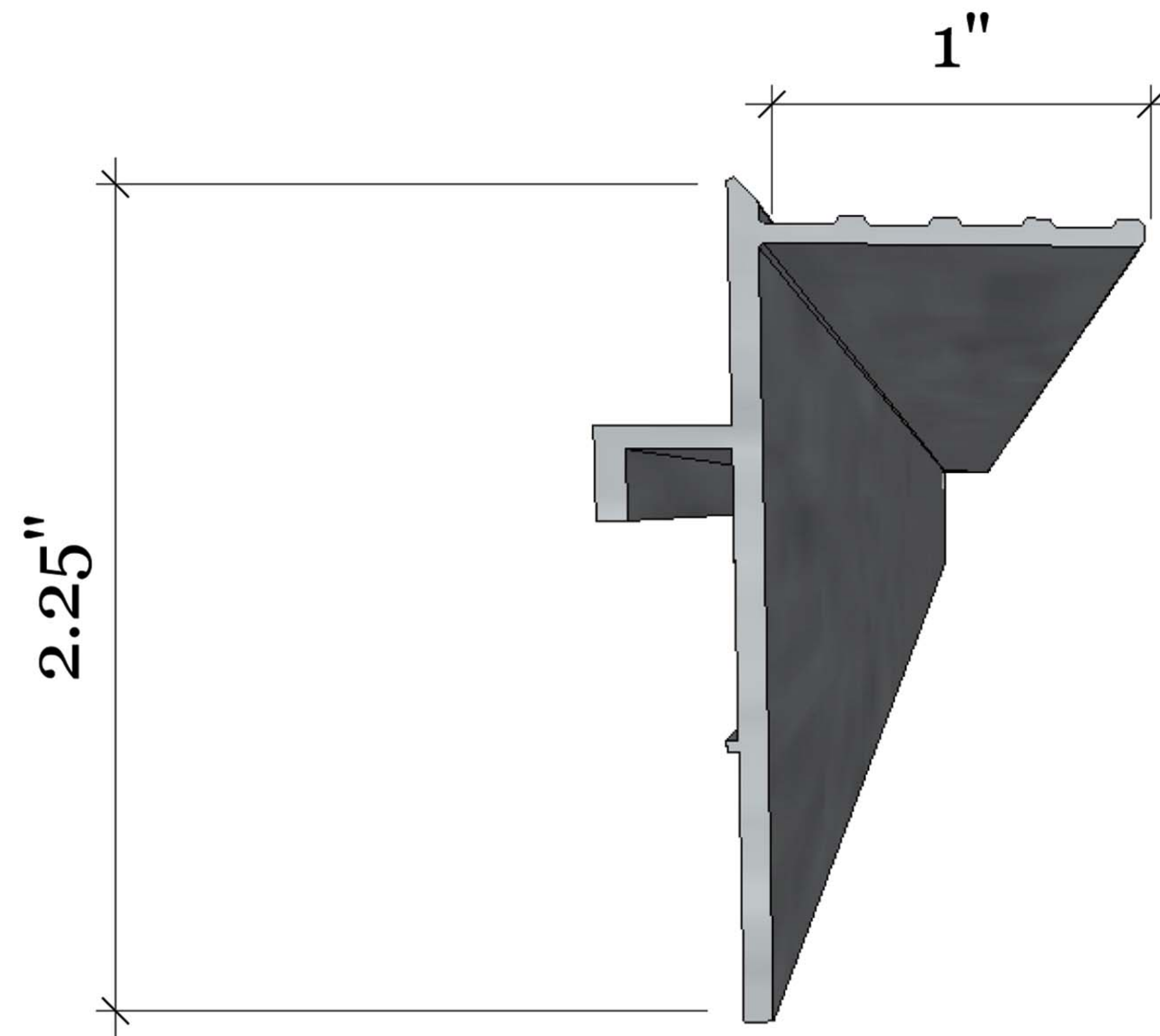

The Process



STEP 1

SPECIFY THE QUANTITY OF
PERFECT FIT MUD IN HANGERS
NEEDED.

PART NUMBERS:

Eight foot extrusions - MIHE8

NOTES:

The extrusion pieces together
seamlessly once mud in. Optionally,
MIH is available in lengths of 16 ft
long. Shipping and handling charges
will be custom quoted.

STEP 2

SPECIFY THE QUANTITY AND
SIZE OF PERFECT FIT MIH
RETURN ENDS REQUIRED FOR
YOUR PROJECT.

PART NUMBERS:

Pair of 3.5" - MIHR35

Pair of 4.75" - MIHR475

Pair of 6" - MIHR6

Pair of 7" - MIHR7

NOTES:

Custom return sizes are available.

STEP 3

PURCHASE YOUR FLAPS FROM
LUTRON.

NOTES:

A. It must be flap for Lutron hanger.
Do not order flap for Lutron pocket as
they have a different profile and will
not pair with MIH.

B. You may purchase the flap from
DEL Motorized Solutions at wholesale
pricing (40% off of Lutron list plus
shipping).



Motorized Solutions

Motorized Solutions®
Toll Free: 866.446.6867
motorizedsolutions.com
info@motorizedsolutions.com